

SKiTCH!

brother

Operation Manual

Embroidery Machine

Product Code: 888-R00

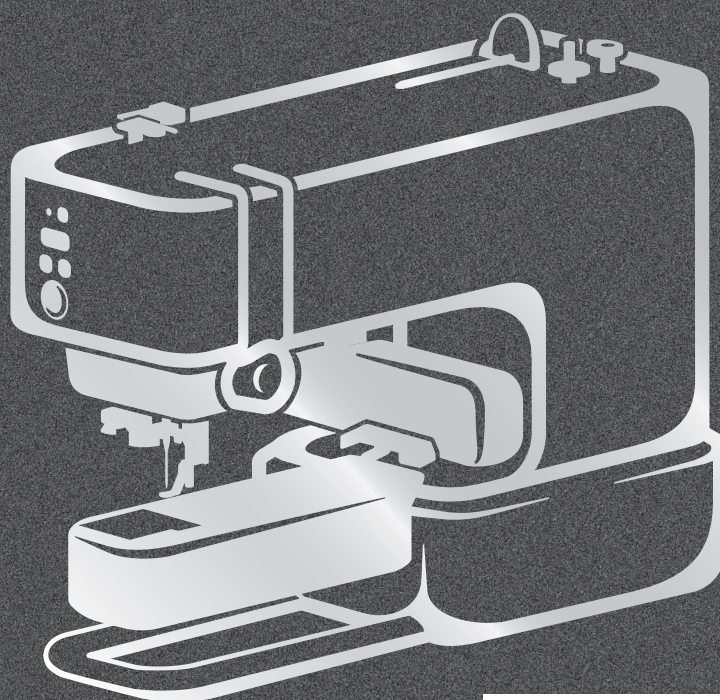

Instructional Videos



<https://s.brother/cvuka/>

Be sure to read this document before using the machine.

We recommend that you keep this document nearby for future reference.

The latest manuals are available at Brother support website (<https://s.brother/cpuaa/>).

INTRODUCTION

Thank you for purchasing this machine. Before using this machine, carefully read the "IMPORTANT SAFETY INSTRUCTIONS", and then study this manual for the correct operation of the various functions.

In addition, after you have finished reading this manual, store it where it can quickly be accessed for future reference.

IMPORTANT SAFETY INSTRUCTIONS

Please read these safety instructions before attempting to use the machine.

DANGER

- To reduce the risk of electrical shock

- 1** Always unplug the machine from the electrical outlet immediately after using, when cleaning, making any user servicing adjustments mentioned in this manual, or if you are leaving the machine unattended.

WARNING

- To reduce the risk of burns, fire, electrical shock, or injury to persons.

- 2** Always unplug the machine from the electrical outlet when making any adjustments mentioned in the instruction manual.

- To unplug the machine, switch the machine to the symbol "O" position to turn it off, then grasp the plug and pull it out of the electrical outlet. Do not pull on the cord.
- Plug the machine directly into the electrical outlet. Do not use an extension cord.
- Always unplug your machine if there is a power failure.

- 3** Electrical Hazards:

- This machine should be connected to an AC power source within the range indicated on the rating label. Do not connect it to a DC power source or inverter. If you are not sure what kind of power source you have, contact a qualified electrician.

- This machine is approved for use in the country of purchase only.

- 4** Never operate this machine if it has a damaged cord or plug, if it is not working properly, has been dropped or damaged, or water is spilled on the unit. Return the machine to the nearest authorized Brother dealer for examination, repair, electrical or mechanical adjustment.

- While the machine is stored or in use if you notice anything unusual, such as an odor, heat, discoloration or deformation, stop using the machine immediately and unplug the power cord.
- When transporting the machine, be sure to carry it by its grips. Lifting the machine by any other part may damage the machine or result in the machine falling, which could cause injuries.
- When lifting the machine, be careful not to make any sudden or careless movements, which may cause a personal injury.

- 5** Always keep your work area clear:

- Never operate the machine with any air vents blocked. Keep ventilation openings of the machine free from the build up of lint, dust, and loose cloth.
- Never drop or insert foreign objects in any opening.
- Do not operate where aerosol (spray) products are being used or where oxygen is being administered.
- Do not use the machine near a heat source, such as a stove or iron; otherwise, the machine, power cord or garment being embroidered may ignite, resulting in fire or an electric shock.
- Do not place this machine on an unstable surface, such as an unsteady or slanted table, otherwise the machine may fall, resulting in injuries.

- 6** Special care is required when embroidering:

- Always pay close attention to the needle. Do not use bent or damaged needles.
- Keep fingers away from all moving parts. Special care is required around the machine needle.
- Switch the machine to the symbol "O" position to turn it off when making any adjustments in the needle area.
- Do not use a damaged or incorrect needle plate, as it could cause the needle to break.

7 This machine is not a toy:

- Your close attention is necessary when the machine is used by or near children.
- This product contains small parts. Keep the product out of the reach of children to prevent accidental ingestion of small parts.
- The plastic bag that this machine was supplied in should be kept out of the reach of children or disposed of. Never allow children to play with the bag due to the danger of suffocation.
- Do not use outdoors.

8 For a longer service life:

- When using and storing this machine, avoid direct sunlight and high humidity locations. Do not use or store the machine near a space heater, iron, halogen lamp, or other hot objects.
- Do not use cleansers or organic solvents, such as thinner, petroleum ether or alcohol, to clean the machine. Otherwise, the finish may peel off or become scratched.
- Do not oil the machine yourself to prevent damaging it.
- Always consult the Operation Manual when replacing or installing any assemblies, the needle or other parts to assure correct installation.

9 For repair or adjustment:

- In the event a malfunction occurs or adjustment is required, first follow the troubleshooting table in the back of the Operation Manual to inspect and adjust the machine yourself. If the problem persists, please consult your local authorized Brother dealer.

Use this machine only for its intended use as described in the manual.

Use accessories recommended by the manufacturer as contained in this manual.

The contents of this manual and specifications of this product are subject to change without notice.

Note that the screens and icons shown in the procedures may differ from the actual ones.

For additional product information and updates, visit our website at www.brother.com

SAVE THESE INSTRUCTIONS

This machine is intended for household use.

FOR USERS IN COUNTRIES EXCEPT EUROPEAN COUNTRIES

This appliance is not intended for use by persons (including children) with reduced physical, sensory or mental capabilities, or lack of experience and knowledge, unless they have been given supervision or instruction concerning use of the appliance by a person responsible for their safety. Children should be supervised to ensure that they do not play with the appliance.

FOR USERS IN EUROPEAN COUNTRIES

This appliance can be used by children aged from 8 years and above and persons with reduced physical, sensory or mental capabilities or lack of experience and knowledge if they have been given supervision or instruction concerning use of the appliance in a safe way and understand the hazards involved. Children shall not play with the appliance. Cleaning and user maintenance shall not be made by children without supervision.

FOR USERS IN THE UK, EIRE, MALTA AND CYPRUS ONLY

IMPORTANT

- In the event of replacing the plug fuse, use a fuse approved by ASTA to BS 1362, i.e. carrying the  mark, rating as marked on plug.
- Always replace the fuse cover. Never use plugs with the fuse cover omitted.
- If the available electrical outlet is not suitable for the plug supplied with this equipment, you should contact your authorized Brother dealer to obtain the correct lead.

Federal Communications Commission (FCC) Supplier's Declaration of Conformity (For U.S.A. Only)

Responsible Party: Brother International
Corporation
200 Crossing Boulevard
P.O. Box 6911
Bridgewater, NJ 08807-0911
USA
TEL : (908) 704-1700

declares that the product

Product Name: Brother Embroidery Machine
Model Number: PP1

This device complies with Part 15 of the FCC Rules. Operation is subject to the following two conditions:
(1) this device may not cause harmful interference, and
(2) this device must accept any interference received, including interference that may cause undesired operation.

This equipment has been tested and found to comply with the limits for a Class B digital device, pursuant to Part 15 of the FCC Rules. These limits are designed to provide reasonable protection against harmful interference in a residential installation. This equipment generates, uses, and can radiate radio frequency energy and, if not installed and used in accordance with the instructions, may cause harmful interference to radio communications. However, there is no guarantee that interference will not occur in a particular installation. If this equipment does cause harmful interference to

radio or television reception, which can be determined by turning the equipment off and on, the user is encouraged to try to correct the interference by one or more of the following measures:

- Reorient or relocate the receiving antenna.
- Increase the separation between the equipment and receiver.
- Connect the equipment into an outlet on a circuit different from that to which the receiver is connected.
- Consult the authorized Brother dealer or an experienced radio/TV technician for help.
- This transmitter must not be co-located or operated in conjunction with any other antenna or transmitter.

Important

Changes or modifications not expressly approved by Brother Industries, Ltd. could void the user's authority to operate the equipment.

This equipment complies with FCC/IC radiation exposure limits set forth for an uncontrolled environment and meets the FCC radio frequency (RF) Exposure Guidelines and RSS-102 of the IC radio frequency (RF) Exposure rules. This equipment should be installed and operated keeping the radiator at least 20cm or more away from person's body.

For Users in Canada

This device complies with Industry Canada's licence-exempt RSSs. Operation is subject to the following two conditions:
(1) This device may not cause interference; and
(2) This device must accept any interference, including interference that may cause undesired operation of the device.

This equipment complies with FCC/IC radiation exposure limits set forth for an uncontrolled environment and meets the FCC radio frequency (RF) Exposure Guidelines and RSS-102 of the IC radio frequency (RF) Exposure rules. This equipment should be installed and operated keeping the radiator at least 20cm or more away from person's body.

For Users in Mexico

The operation of this equipment is subject to the following two conditions:

- (1) it is possible that this equipment or device may not cause harmful interference, and
- (2) this equipment or device must accept any interference, including interference that may cause undesired operation.

La operación de este equipo está sujeta a las siguientes dos condiciones:

- (1) es posible que este equipo o dispositivo no cause interferencia perjudicial y
- (2) este equipo o dispositivo debe aceptar cualquier interferencia, incluyendo la que pueda causar su operación no deseada.

Declaration of Conformity (Europe and Turkey only)

We, Brother Industries, Ltd. 15-1 Naeshiro-cho, Mizuho-ku, Nagoya 467-8561 Japan declare that this product is in conformity with the essential requirements of all relevant directives and regulations applied within the European Community.

The Declaration of Conformity (DoC) can be downloaded from Brother support website. Visit support.brother.com

Declaration of Conformity for RE Directive 2014/53/ EU (Europe and Turkey only) (Applicable to models with radio interfaces)

We, Brother Industries, Ltd. 15-1 Naeshiro-cho, Mizuho-ku, Nagoya 467-8561 Japan declare that these products are in conformity with the provisions of the RE Directive 2014/53/EU.

The Declaration of Conformity (DoC) can be downloaded from Brother support website. Visit support.brother.com

Bluetooth (Models with Bluetooth function only)

This machine supports Bluetooth.
Frequency band(s): 2400-2483.5 MHz.
Maximum radio-frequency power transmitted in the frequency band(s): Less than 20 dBm (e.i.r.p).

UK Declaration of Conformity (Great Britain only)

We, Brother Industries, Ltd. 15-1 Naeshiro-cho, Mizuho-ku, Nagoya 467-8561 Japan declare that these products are in conformity with the relevant UK legislation.

The Declaration of Conformity (DoC) can be downloaded from Brother support website. Visit support.brother.com

UK Declaration of Conformity for Radio Equipment Regulation 2017 (Great Britain only) (Applicable to models with radio interfaces)

We, Brother Industries, Ltd. 15-1 Naeshiro-cho, Mizuho-ku, Nagoya 467-8561 Japan declare that these products are in conformity with the provisions of the Radio Equipment Regulation 2017.

The Declaration of Conformity (DoC) can be downloaded from Brother support website. Visit support.brother.com

WARNING SIGN

■ Embroidery frame (Magnetic frame)

The following warning label pertains to the magnetic frame:

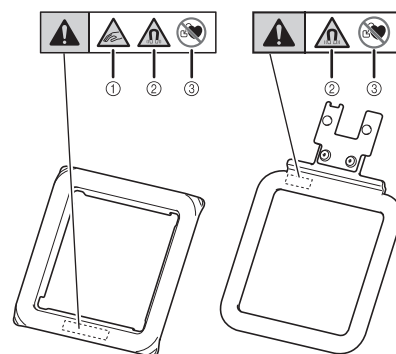

The embroidery frames contain magnets.

- ① When removing or fitting the upper frame, be careful not to pinch your fingers. Fingers may be injured if they get caught.
- ② Be sure to keep this product away from precision electronics, computer disks, credit cards with a magnetic stripe, etc.
- ③ Do not use this product if you have a pacemaker.

TRADEMARKS

The Bluetooth® word mark and logos are registered trademarks owned by the Bluetooth SIG, Inc. and any use of such marks by Brother Industries, Ltd. and related companies is under license. Other trademarks and trade names are those of their respective owners.

Any trade names and product names of companies appearing on Brother products, related documents and any other materials are all trademarks or registered trademarks of those respective companies.

Terms of Use

IMPORTANT-PLEASE READ CAREFULLY:

This Terms of Use ("Agreement") is a legal agreement between Brother Industries, Ltd. ("Company") and you that governs your use of any Software, installed on or made available by Company for use with embroidery products ("Company Product"). The term of "Software" means any and all contents data (including without limitation design and embroidery data, collectively "Content"), data format, firmware of Company Product, and PC application or mobile device application.

Please note that installation of the contents editing application software provided separately by Company ("Company App") is required on your device (such as mobile device) which is connected to Company Product to use Company Product. Please see Operation Manual for the details.

By using the Software and Company Product, you shall be deemed to have agreed to be bound by the terms of this Agreement. If you do not agree to the terms of this Agreement, Company is unwilling to license the Software and you are not allowed to use the Software. Amendments and supplements to this Agreement may be attached to the Software.

An individual who accepts this Agreement on behalf of an entity represents to Company that he or she has the legal right to enter into a binding legal agreement for that entity.

Terms and Conditions

1 Grant of License.

- 1.1 Subject to this Agreement, Company hereby grants you a personal, non-exclusive, non-transferable and revocable license to use the Software only within the Company Product.
- 1.2 Your right to use of the Software is licensed and not sold, and solely for your use subject to this Agreement. Company or its suppliers retains all right, title, and interest relating to Software, including without limitation all intellectual property rights relating thereto.

2 Restrictions

- 2.1 Except as expressly set out in this Agreement or as required by any local law, you shall undertake:
 - 2.1.1 not to disassemble, de-compile, reverse engineer, translate or otherwise attempt to learn the source code of the Software (including Content created by using Company Product or Company App; hereinafter the same shall apply in this Clause 2.);
 - 2.1.2 not to create derivative works based on the whole or any part of the Software, but excluding, Your Content set forth in Clause 7.2;
 - 2.1.3 not to distribute, provide or make available the Software in any form, in whole or in part to any person without prior written consent from Company;
 - 2.1.4 not to copy the Software, except where such copying is incidental to normal use of the Software with Company Product or where it

is necessary for the purpose of back-up or operational security;

- 2.1.5 not to transfer, rent, lease, sub-license, loan, translate, merge, adapt, vary, alter or modify, the whole or any part of the Software nor permit the Software or any part of it to be combined with, or become incorporated in, any other programs;
- 2.1.6 to include Company's or its licensor's copyright notice and this Agreement on all entire and partial copies of the Software; and
- 2.1.7 not to use the Software for any purpose (including, but not limited to, use with unauthorized sewing/embroidery/craft products or software) other than as provided under Clause 1 of this Agreement.

3 No warranty

TO THE EXTENT PERMISSIBLE BY APPLICABLE LAW, THIS SOFTWARE IS PROVIDED TO YOU "AS IS" WITHOUT WARRANTIES OR CONDITIONS OF ANY KIND, WHETHER ORAL OR WRITTEN, EXPRESS OR IMPLIED. COMPANY SPECIFICALLY DISCLAIMS ANY IMPLIED WARRANTIES OR CONDITIONS OF MERCHANTABILITY, SATISFACTORY QUALITY, NON-INFRINGEMENT AND/OR FITNESS FOR A PARTICULAR PURPOSE.

4 Limitation of liability

- 4.1 COMPANY SHALL NOT BE LIABLE TO YOU, ITS END-USERS OR ANY OTHER ENTITY FOR ANY LOSS OF PROFITS OR INCOME OR SAVINGS, LOSS OF DATA, INTERRUPTION OF USE, OR CONSEQUENTIAL, INCIDENTAL, SPECIAL, PUNITIVE OR INDIRECT DAMAGES INCURRED BY SUCH PARTY (WHETHER IN AN ACTION IN CONTRACT OR TORT), EVEN IF COMPANY HAS BEEN ADVISED OF THE POSSIBILITY OF SUCH DAMAGES, ARISING OUT OF OR RELATING TO THE SOFTWARE, SUPPORT SERVICE OR THIS AGREEMENT. THESE LIMITATIONS SHALL APPLY TO THE MAXIMUM EXTENT ALLOWED BY APPLICABLE LAW NOTWITHSTANDING ANY FAILURE OF ESSENTIAL PURPOSE OF ANY LIMITED REMEDY.
- 4.2 NOTWITHSTANDING THE CLAUSE 3 OR 4.1 HEREOF, THIS AGREEMENT DOES NOT PURPORT TO EXCLUDE OR RESTRICT COMPANY'S LIABILITY FOR DEATH OR PERSONAL INJURY RESULTING FROM NEGLIGENCE OR LIMIT THE STATUTORY RIGHTS OF A CONSUMER.

5 Cost, charge incurred for your use of the Software.

- 5.1 You agree and understand that service(s) available by the Software may be provided through any network communication and therefore, during the course of your using the Software, any communication charge due to utilization of such networks will occur, and you shall bear such charge.
- 5.2 In addition to the above charge, you are solely responsible for any costs or expenses incurred by you in connection with your use of the Software.
- 5.3 In no event shall Company reimburse you for any of the above charge, costs or expenses.

6 Support and Updates.

Company reserves the right, at its sole discretion, and with or without notice to you, to add or remove features or functions to or from the Software, or to provide programming fixes, enhancements, updates and upgrades, to the Software (collectively "Updates"). You agree that Company has no obligation to provide you with Updates, or make available to you any subsequent versions of the Software. You also agree that you may, in Company's sole discretion, be required to enter into a modified version of this Agreement if you want to use an Updates.

7 Use of Content

- 7.1 You may use any Content uploaded or recorded or otherwise made available using, through or in connection with Company App connected to the Software by Company and its licensor (collectively "Company Content"). You may at least create hand-made craftwork items and use such hand-made craftwork items for private use by using Company Content. Any requirements in such private use (e.g. editing restrictions) and other conditions for use (e.g. prohibited commercial use of hand-made craftwork items) may depend on Company Content, respectively. Please see End User License Agreement accompanied by Company App connected to the Software.
- 7.2 You may produce new Content using this Software or other devices connected to the Software by creating or editing. If you produce new content ("Your Content"), you shall use such Your Content at your own risk.

8 Your Obligations in respect of the Software

You warrant that you will:

- A) comply with all applicable laws, regulations and codes of practice with respect to your use of the Software;
- B) not use the Software in a way which is unlawful, defamatory, obscene, indecent, offensive or threatening or which infringes the Intellectual Property Rights of any third party; and
- C) not distribute or transmit any viruses, worms, Trojan horses or any other technologically harmful data, programs or software through, via or using the Software.

9 Termination

- 9.1 Company shall have the right to terminate this Agreement at any time by providing a written notice to you if you commit a material breach of any terms of this Agreement and fail to immediately rectify such breach upon Company's request.
- 9.2 Upon termination for any reason all rights granted to you under this Agreement, you shall cease all activities authorized by this Agreement and you shall immediately delete or remove the Software from all computer equipment in your possession and delete or destroy all copies of the Software or its derivative works in your possession. In addition to the above, you shall delete Content created by you from the Company Product in your possession.

10 Miscellaneous terms

- 10.1 You shall not export or re-export the Software or any copy or adaptation thereof in violation of any applicable laws or regulations.

- 10.2 Except for cases where transferring Company Products together with ownership, you shall not assign all or any part of this Agreement to any third party or any interest therein, without prior written consent of Company. A change of control or reorganization of you pursuant to a merger, sale of assets or stock shall be deemed to be an assignment under this Agreement.
- 10.3 You agree that a breach of this Agreement will cause irreparable injury to Company for which monetary damages would not be an adequate remedy and Company shall be entitled to seek equitable relief in addition to any remedies it may have hereunder or at law without a bond, other security, or proof of damages.
- 10.4 If any provisions of this Agreement shall be declared or determined as void or unenforceable by a court of competent jurisdiction, such provisions shall be severable and independent from the other provisions of this Agreement and the validity of the other provisions and of the entire Agreement shall not be affected thereby.
- 10.5 This Agreement, together with all exhibits or other attachments referenced herein, constitutes the entire agreement between the parties on the subject matter hereof, and supersedes all proposals, oral and written, between the parties on this subject.
- 10.6 If Company fails to insist that you perform any of your obligations under this Agreement, or if Company does not enforce any rights against you, or if Company delay in doing so, that will not mean that Company have waived any rights against you and will not mean that you do not have to comply with those obligations. If Company does waive a default by you, Company will only do so in writing, and that will not mean that Company will automatically waive any later default by you.
- 10.7 This Agreement is governed by the laws of Japan and Japanese Courts shall have exclusive jurisdiction with respect to this Agreement except with regard to enforcement in which case the jurisdiction of the Japanese Courts shall be non-exclusive.
- 10.8 The Company may update this Agreement in the following cases: A) When the changes are made for the users' benefit, or B) When the updates to the Agreement are adequate, reasonable, and not contrary to the purposes of the Agreement. Notwithstanding the foregoing, in principle, the contents of the amendments or modifications shall be published on the Company's website or by any other appropriate methods before the effective date of the amendments or modifications and enter into effect from the date that is separately specified in the notification.

11 Third-Party Software

The Software may contain third-party software and/or open source software programs (collectively, "Third-Party Software"). As for details of the Third-Party Software, please refer to the terms and condition separately defined.

BASIC PROJECT FLOW

The general flow for completing a project is shown below. Review the explanation for each step, provided in this Operation Manual.

An instructional video is available for items marked with



Use the QR code below to access the list of available instructional videos.



<https://s.brother/cvuka/>

Preparing the machine and app

Install Brother Artspira app on your mobile device, and then pair the app and the machine. (page 13)



Selecting an embroidery pattern

- (1) Select the embroidery pattern in the app. (page 14)
- (2) Hoop the fabric (with stabilizer) in the embroidery frame. (page 14)
- (3) Adjust the embroidering position and transfer the embroidery pattern data to the machine. (page 16, page 17)



Preparing the bobbin

Install the bobbin wound with thread into the machine. (page 20)



Embroidering

- (1) Attach the embroidery frame to the machine. (page 22)
- (2) Check the thread embroidering order in the app, and then thread the machine with each color of upper thread, one at a time. (page 24)
- (3) Embroider all thread colors.



Completed



Check the finished embroidery.

THE LIST OF THE INSTRUCTION MANUALS



Name	Content	Reference
Operation Manual (Printed)	Instructions for fundamental usage of this machine with the app. Be sure to read this document before using the machine.	Printed/Included with the machine
Operation Manual (Web)	In addition to the printed Operation Manual, useful app's functions, such as editing a pattern and settings of the machine, are introduced.	Brother support website https://s.brother/cmuka/ 
Quick Reference Guide	Simple instructions for setting up and embroidering a pattern.	Printed/Included with the machine
Included Accessories	A list of included accessories with this product.	Printed/Included with the machine

HOW TO READ ICONS



• Operated devices

Icon	Description
	Operations performed with the machine.
	Operations performed with the app.

• LED indicators

Icon	Description
	Off
	Blinking
	Steady light

• How to press buttons

Icon	Description
	Press a button.
	Hold down a button. *Hold down for more than 2 seconds.

CONTENTS

Chapter 1 GETTING READY	10
Names of Machine Parts	10
When transporting the machine	11
Items to Prepare	11
Setting Up the Machine	12
Turning the machine on.....	12
Connecting the machine and app.....	13
Setting the embroidery carriage to the initial position.....	13
Chapter 2 EMBROIDERY	14
Selecting an Embroidery Pattern	14
Hooping the Fabric in the Embroidery	
Frame	14
Attaching stabilizer (backing) to the fabric.....	15
Inserting the fabric to the embroidery frame	
(magnetic frame)	15
Adjusting the Embroidering Position ([Camera	
Scan] Function)	16
Transferring the Pattern Data	17
Winding/Installing the Bobbin	18
Winding the bobbin.....	18
Installing the bobbin	20
Needle/thread exchange mode	21
Attaching the Embroidery Frame	22
Upper Threading	24
Embroidering a Pattern	26
Adjusting Thread Tension	29
Chapter 3 APPENDIX	30
Care and Maintenance of the Machine	30
Cleaning the machine surface	30
Restrictions on oiling	30
Precautions on using and storing the machine	30
Cleaning the race	31
Replacing the Needle	32
Checking the needle.....	32
Replacing the needle.....	32
Troubleshooting	33
LED indications	33
If a communication error occurs	33
If the thread becomes tangled under the bobbin winder	
seat.....	34
List of symptoms	34
Error messages	37
Updating Your Machine's Software	38
Before Lending or Disposing of the Machine...	38
Specifications	39
INDEX	40

Chapter 1 GETTING READY

Names of Machine Parts

■ Main parts

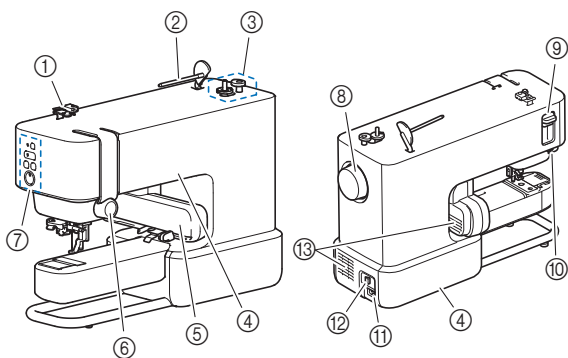

- ① **Thread guide**
- ② **Spool pin**
- ③ **Bobbin winder**
- ④ **Grips (2 locations)**
Use the grips to transport the machine. (page 11)
- ⑤ **Embroidery carriage**
- ⑥ **Thread tension dial**
- ⑦ **Operation buttons and LED** (page 10, page 33)
- ⑧ **Handwheel**
Turn the handwheel toward the thread tension dial to raise and lower the needle.
- ⑨ **Needle threader lever**
- ⑩ **Thread cutter**
- ⑪ **Power supply jack**
- ⑫ **Main power switch**
Press the right side of the switch ("I") to turn it on, and the left side ("O") to turn it off.
- ⑬ **Air vents (2 locations)**
The air vents allow the air surrounding the motor to circulate. Do not cover the air vents while the machine is being used.

■ Needle and presser foot section

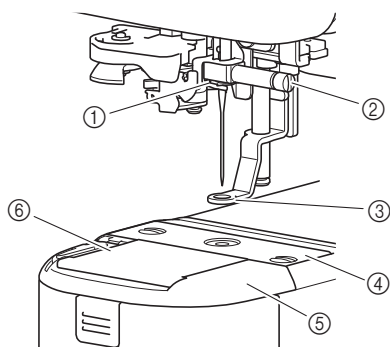

- ① **Needle bar thread guide**
- ② **Needle clamp screw**
- ③ **Presser foot**
The presser foot helps control fabric flexibility for better stitch consistency.
- ④ **Needle plate**
- ⑤ **Needle plate cover**
- ⑥ **Bobbin cover**

■ Operation buttons and LED

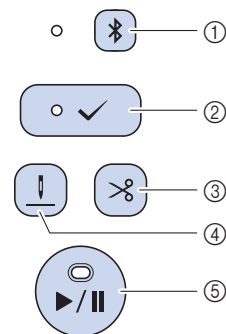

- ① **Bluetooth button**
Hold down to pair the machine and the app via Bluetooth. (page 13)
The LED beside the button changes its lighting depending on the connection status between the machine and the app.
- ② **Accept button**
Press this button according to the instructions of the app when LED blinking.
Hold down this button to enter Needle/thread exchange mode. (page 21).
- ③ **Thread cutter button**
Press to cut the upper thread and the bobbin thread when embroidering is finished.
- ④ **Threading position button**
Press to move the needle position (the height) appropriate for threading.
- ⑤ **"Start/Stop" button**
Press to start or stop embroidering. The color and lighting condition of the LED change depending on the status of the machine.

For details on the LED lighting conditions, refer to "LED indications" on page 33.

■ Embroidery frame (Magnetic frame)

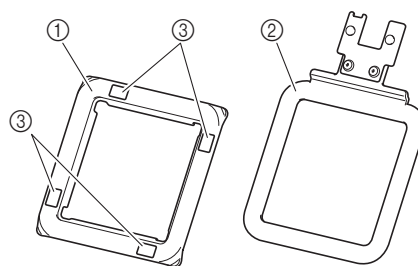

- ① **Upper frame**
- ② **Base frame**
- ③ **Marks for [Camera scan] function**

When transporting the machine

⚠ CAUTION

When transporting the machine, be sure to carry it by its grips (recess and support). Lifting the machine by any other part may damage the machine or result in the machine falling, which could cause injuries.

Transport the machine by 2 grips on the right side (recess) and on the left side (support).

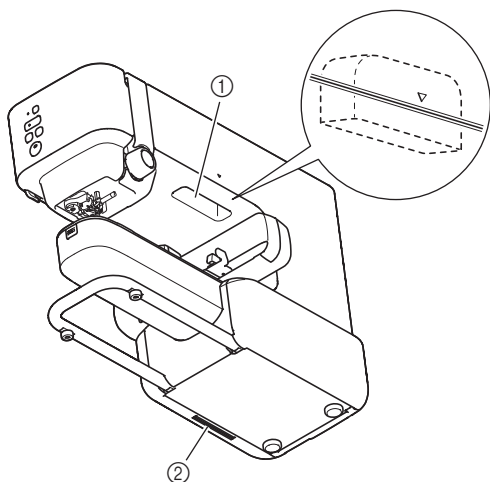

- ① Recess
- ② Support

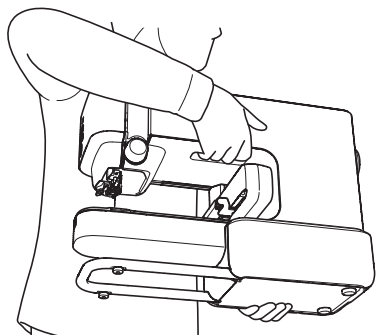
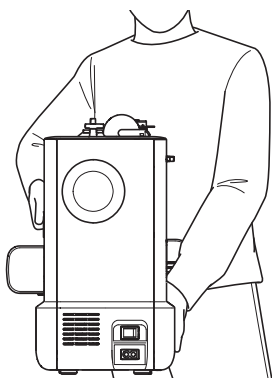

Items to Prepare

Fabric and Stabilizer

Stabilizer is a piece of specialty product used under the fabric to support it during the embroidery process to ensure the best results.

Prepare stabilizer that is larger than the embroidery frame. For details on using commercial stabilizer, refer to the instructions included with it.

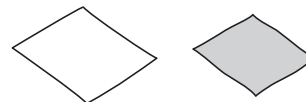

Embroidery thread (upper and bobbin threads)

Upper thread:

Prepare the colors needed for the pattern. Brother embroidery thread is recommended. Other embroidery threads may not yield optimum results.



Bobbin thread (or Pre-wound bobbin):

This thread is wound onto the bobbin and sewn on the wrong side of the fabric. Use the included bobbin pre-wound with 90 weight embroidery bobbin thread or recommended 90 weight embroidery bobbin thread.



Needle (on machine)

Use a 75/11 home sewing machine needle.

If the machine is not stitching well when embroidering on heavy weight fabric, please try a 90/14 needle. (page 32)



Mobile device

This machine is controlled by an app. Install the Brother Artspira app on your mobile device, and then use the app to edit patterns and operate the machine.

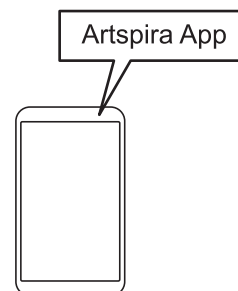

Setting Up the Machine

Turning the machine on

⚠ WARNING

- Use only regular household electricity for the power source. Using other power sources may result in fire, electric shock, or damage to the machine.
- Do not touch the plug with wet hands. Electric shock may result.
- Make sure that the plugs on the power cord are firmly inserted into the electrical outlet and the power cord receptacle on the machine. Otherwise, a fire or electric shock may result.
- Turn the main power to OFF and remove the plug in the following circumstances:
 - When you are away from the machine
 - After using the machine
 - When the power fails during use
 - When the machine does not operate correctly due to a bad connection or a disconnection
 - During electrical storms

⚠ CAUTION

- Use only the power cord included with this machine. Otherwise, a fire or electric shock may result.
- Do not use extension cords or multi-plug adapters with any other appliances plugged into them. Fire or electric shock may result.
- When unplugging the machine, always turn the main power to OFF first. Always grasp the plug to remove it from the electrical outlet. Pulling on the cord may damage the cord, or lead to fire or electric shock.
- Do not allow the power cord to be cut, damaged, modified, forcefully bent, pulled, twisted, or bundled. Do not place heavy objects on the cord. Do not subject the cord to heat. These things may damage the cord, or cause fire or electric shock. If the cord or plug is damaged, take the machine to your authorized Brother dealer for repairs before continuing use.
- Do not insert the plug on the power cord into an electrical outlet that is in poor condition.
- (For U.S.A. only)
This appliance has a polarized plug (one blade wider than the other). To reduce the risk of electrical shock, this plug is intended to fit in a polarized electrical outlet only one way. If the plug does not fit fully in the electrical outlet, reverse the plug. If it still does not fit, contact a qualified electrician to install the proper electrical outlet. Do not modify the plug in any way.

- 1** Make sure that the machine is turned off (the main power switch on the back of the machine is set to "O"), and then plug the power cord into the power supply jack under the main power switch.
- 2** Insert the plug of the power cord into a household electrical outlet.

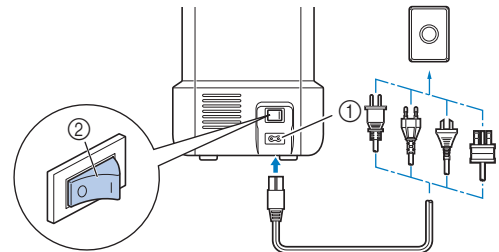

- ① Power supply jack
- ② Main power switch

- 3** Press the right side of the main power switch to turn the machine on (set it to "I").

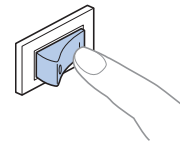

Note

To turn off the machine, press the left side of the main power switch (set it to "O").

Connecting the machine and app

Download the app to your mobile device, and then pair the app and machine via Bluetooth.

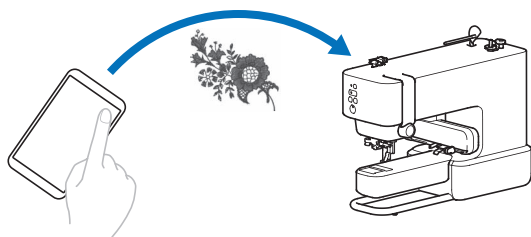

■ Installing the app

 : App

- 1 Access Google Play or the App Store on your mobile device.



- 2 Install the [Brother Artspira] app.

■ Pairing the machine and app

 : App

- 1 In the home screen, tap .
- 2 Select [Embroidery Machine] → [Bluetooth Model].
→ A screen for specifying pairing settings appears.

 : Machine

- 3 Hold down  (Bluetooth button).
Hold down the button until a beep sounds and the LED starts blinking at 1.5 second intervals.

 : App

- 4 Select the machine to be paired.

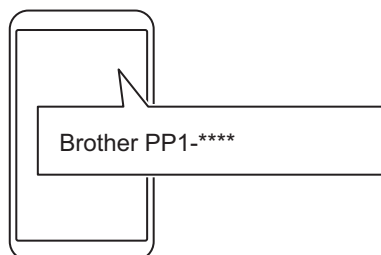

The machine name appears as "Brother PP1" and a 4-digit number. This number is the last four digits of the serial number of the machine. The machine's serial number can be found in the label on the back of the machine.

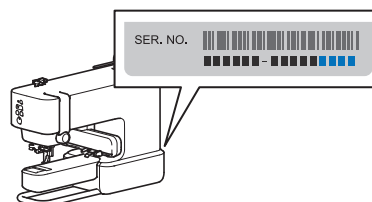

- When pairing is finished, [Ready for transferring] appears in the app screen, and the LED beside  (Bluetooth button) on the machine lights steadily.

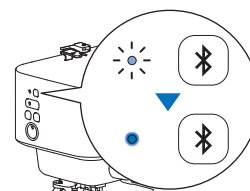
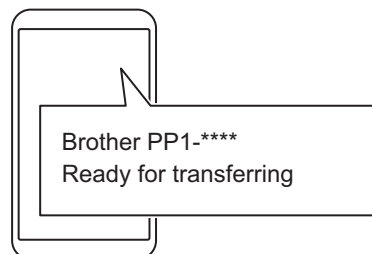

- 5 Go back to the app's home screen.

Note

- The app can be paired with only one machine at a time. To pair the app with a different machine, select that machine when performing the pairing operation again.
- To pair the machine with a different device, hold down  (Bluetooth button) on the machine to prepare for re-pairing, and then perform the pairing operation from that app.

Setting the embroidery carriage to the initial position

Before attaching the embroidery frame, prepare the machine by moving the embroidery carriage to its initial position.

- 1 Press  (Accept button) to move the embroidery carriage position.

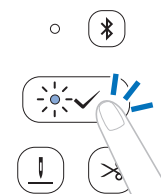

The embroidery carriage will move.

IMPORTANT

Keep your hands and other objects away from the embroidery carriage and frame when they are moving. Otherwise, damage or malfunction may occur to the machine.

Chapter 2 EMBROIDERY

Selecting an Embroidery Pattern

In the app, select the pattern to be embroidered.

 : App

- 1 From the home screen of the app, select the pattern to be embroidered.

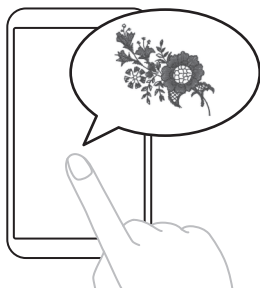

- 2 Confirm the pattern.

Hooping the Fabric in the Embroidery Frame

CAUTION

- Use fabrics with a thickness of less than 2 mm (approx. 1/16 inch). Using fabrics thicker than 2 mm (approx. 1/16 inch) may cause the needle to break, possibly resulting in injury.
- Always use a stabilizer material for embroidery when embroidering. Otherwise, the needle may break and cause injury especially when embroidering stretch fabrics, lightweight fabrics, fabrics with a coarse weave, or fabrics which cause pattern shrinkage.

Note

- When storing the frame, place fabric between the base and upper frames. If the upper frame is attached directly to the base frame, it will be difficult to detach.
- Before using the embroidery frame, check that there are no items (metal object such as needles and pins) stuck to the frames. If any items are stuck to the surface, they may affect the embroidering quality or damage the main unit of the machine.
- Do not use stiff or elastic material or thick jackets, etc. Otherwise, the upper frame may not attach to the base frame or may come off the base frame, or the material may become caught on the presser foot, preventing proper embroidering.
- Use fabric with a thickness no more than 2 mm (approx. 1/16 inch). When embroidering specially processed fabrics, such as those with a non-slip lining, embroidering may not be possible even if the fabric thickness is less than 2 mm (approx. 1/16 inch).
- When embroidering on cylindrical items with a small opening, use "Trial run" to check that the frame moves without getting caught (page 22). Otherwise, the frame may get caught during embroidering.

Attaching stabilizer (backing) to the fabric

- 1 Press the iron-on stabilizer material to the wrong side (bottom) of the fabric.

Use a piece of stabilizer which is larger than the embroidery frame being used.

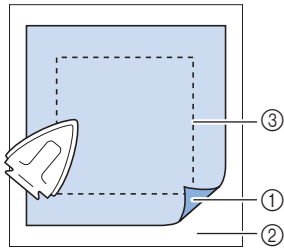

- ① Fusible side of stabilizer
- ② Fabric (wrong side (bottom))
- ③ Size of the embroidery frame

Note

For details on using commercial stabilizer, refer to the instructions included with it.

Inserting the fabric to the embroidery frame (magnetic frame)

CAUTION

When removing or fitting the upper frame, be careful not to pinch your fingers. Fingers may cause injury if they get caught.

- 1 Separate the upper frame and the base frame.

The upper frame and base frame are attached with strong magnets. Applying upward and downward forces with your fingers in the upper corner of the frame will make it easier to separate the frames.

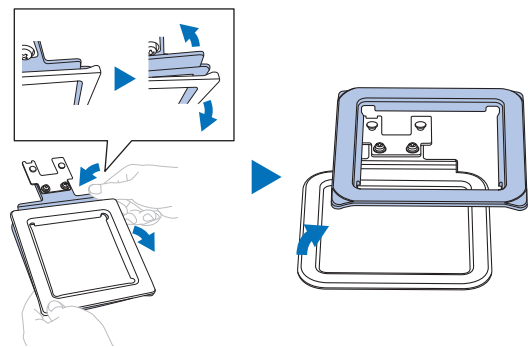

- 2 Place the base frame on a flat surface. Place the fabric with stabilizer attached on top of the frame.

Place the fabric right side up.

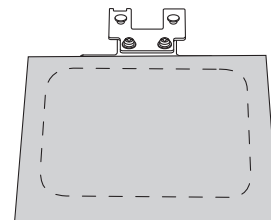

- 3 Place the upper frame on top.

Make sure that the fabric is taut.

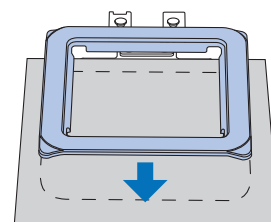

- 4 Grab the upper frame and slightly lift up the frame to confirm that the upper frame securely holds the fabric without coming off.

Adjusting the Embroidering Position ([Camera Scan] Function)

For easier adjustment of the embroidering position, use this function to import into the app an image of the fabric to be embroidered.

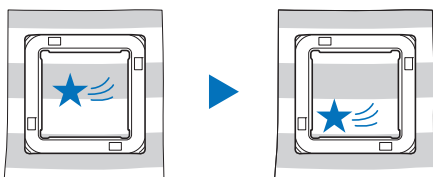

 : App

- 1 Tap [Layout] after selecting a pattern.

Note

If no machine is selected on the app, [Layout] will not be displayed. Make sure your machine is selected on the app's screen.

- 2 Tap the camera icon in the upper-left corner of the screen.

→ The [Camera scan] function opens the camera function on your mobile device.

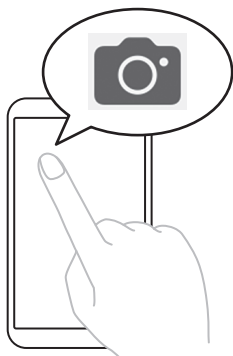

- 3 Place the embroidery frame (with the fabric hooped) on a flat surface, and then set the entire embroidery frame in the screen.

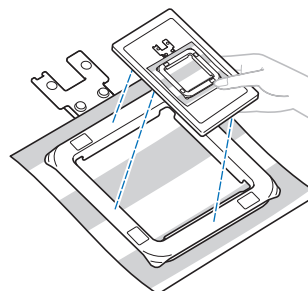

IMPORTANT

Do not remove or damage the marks for the [Camera scan] function. Otherwise, the function will become unusable.

Note

When using the [Camera scan] function, make sure that the marks are visible in the screen and are not covered with fabric, etc.

- 4 When the embroidery frame outline appears on the screen, align that outline with the embroidery frame.

Hold your mobile device parallel to the embroidery frame.

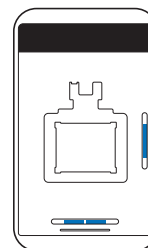

- 5 After an image is imported, tap [OK].

→ The selected pattern appears on the image of the fabric.

- 6 Drag the pattern to the desired position.

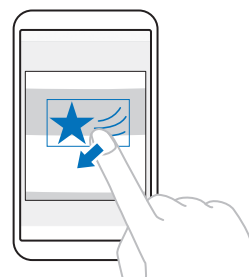

The pattern can also be rotated.

Tap  at the bottom of the screen to make fine adjustments.

- 7 Tap [Done].

Transferring the Pattern Data

 : App

- 1 Tap [Transfer] to transfer the pattern data to the machine.

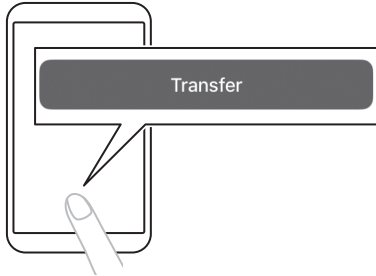

- 2 Make sure that [Data Sent] is displayed in the app, and then tap [Done].

Note

[Transfer] is disabled when no machine is selected on the app. Make sure your machine is selected on the app's screen.

Winding/Installing the Bobbin

Install the bobbin in the machine.

IMPORTANT

Use the plastic bobbins that came with this machine or bobbins of the same type: 11.5 mm (approx. 7/16 inch) high plastic Class 15 bobbins.

There are 2 options for bobbins;

1. Use a pre-wound bobbin.
Go to "Installing the bobbin" on page 20.
2. Wind a bobbin with the machine.
Continue to read the following instructions.

Winding the bobbin

Wind the bobbin with bobbin thread. Be sure to use the recommended 90 weight embroidery bobbin thread for this machine.

If a pre-wound bobbin is being used, it is not necessary to wind the bobbin. Continue with the next section ("Installing the bobbin").

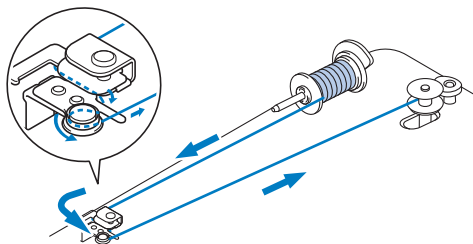

- 1 Place the bobbin on the bobbin winder shaft so that the notch in the bobbin aligns with the spring on the shaft. And then slide the bobbin winder shaft to the rear until it snaps into place.

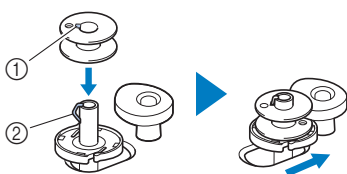

- ① Notch
- ② Bobbin winder shaft spring

Note

When inserting the bobbin into the bobbin case, insert it with the same orientation as when it was wound. Use the "b" mark engraved on one side of the included bobbin as a reference.

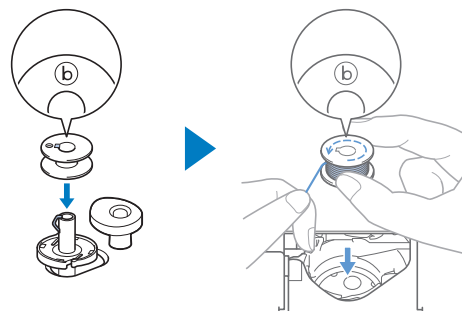

- 2 Raise the spool pin and place the spool of thread for the bobbin onto the spool pin.

Make sure that the thread unwinds as shown.

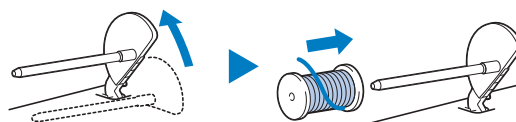

- 3 Slide the spool cap onto the spool pin.

Slide the spool cap as far as possible to the rear, as shown, with the rounded side out.

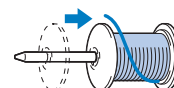

IMPORTANT

- If the spool or the spool cap is not installed correctly, the thread may become tangled around the spool pin, and the machine may be damaged.
- Three spool cap sizes are available, allowing you to choose a spool cap that best fits the size of spool being used. If the spool cap is too small for the spool being used, the thread may catch on the slit in the spool or the machine may be damaged. When using mini king thread spool, use the thread spool insert (mini king thread spool).



Note

When using the spool as shown below, use the thread spool insert (mini king thread spool). Make sure that the thread spool insert is firmly inserted. After installing it, pull out some thread, and check that the thread unwinds without getting caught.

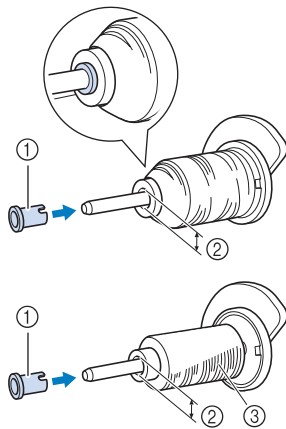

- ① Thread spool insert (mini king thread spool)
- ② Hole diameter 8.0 mm to 10.5 mm (approx. 5/16 inch to 13/32 inch)
- ③ Spool (crosswind thread)

4 Pass the thread under the thread guide and the tab.

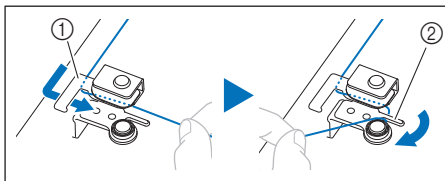

- ① Thread guide
- ② Tab

5 Wind the thread counterclockwise around the pretension disk.

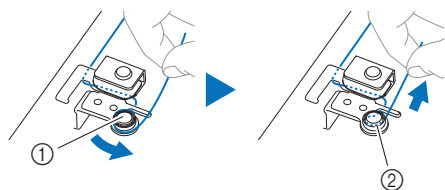

- ① Pretension disk
- ② Pull the thread in as far as possible.

6 Wind the thread clockwise around the bobbin 5 or 6 times. And then pass the thread through the guide slit in the bobbin winder seat, and then pull the thread to cut it.

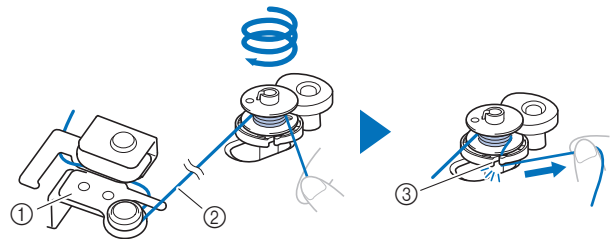

- ① Bobbin winding thread guide
- ② Pull the thread taut.
- ③ Guide slit in bobbin winder seat (with built-in cutter)

Note

Be sure to wind the thread clockwise around the bobbin, otherwise the thread will become wrapped around the bobbin winder shaft.

CAUTION

Be sure to cut the thread with the cutter built into the guide slit in the bobbin winder seat. Otherwise, the thread may become tangled in the bobbin or the needle may break and cause injury when the bobbin thread starts to run out.

7 Press the “Start/Stop” button to start winding the bobbin.

8 When the bobbin winding becomes slow, press the “Start/Stop” button to stop the machine.

IMPORTANT

When the bobbin winding becomes slow, stop the machine, otherwise the machine may be damaged.

9 Cut the thread, slide the bobbin winder shaft toward the front until it snaps into place, and then remove the bobbin.

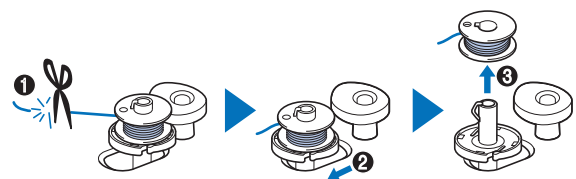

10 Remove the spool for the bobbin thread from the spool pin.

Installing the bobbin



Install the bobbin wound with thread. You can begin embroidering immediately without pulling up the bobbin thread by simply inserting the bobbin in the bobbin case and guiding the thread through the slit.

⚠ CAUTION

- Use a bobbin that has been correctly wound with thread, otherwise there is a risk of poor thread tension or injury due to the needle breaking.



- Before inserting or changing the bobbin, be sure that you have held down the Accept button to lock all buttons for needle moving. Otherwise, injuries may occur if the "Start/Stop" button or any other button is pressed and the machine starts.

- 1 Press  (Threading position button) to raise the needle.**
- 2 Hold down  (Accept button).**
→ The machine enters Needle/thread exchange mode. (page 21) The Accept button LED blinks and the "Start/Stop" button LED lights steadily in orange. All buttons except the Accept button are locked.
- 3 Open the bobbin cover.**

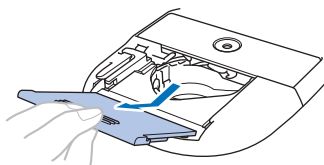

- 4 Insert the bobbin into the bobbin case so that the thread unwinds to the left.**

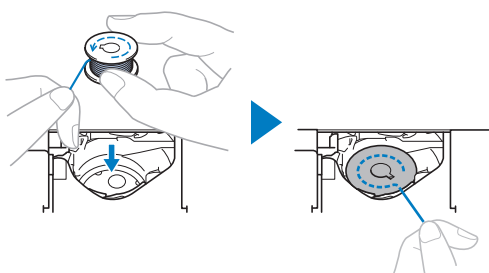

💡 Note

When you wound the bobbin thread with this machine, insert the bobbin with the same orientation as when it was wound. The thread unwinds to the left.

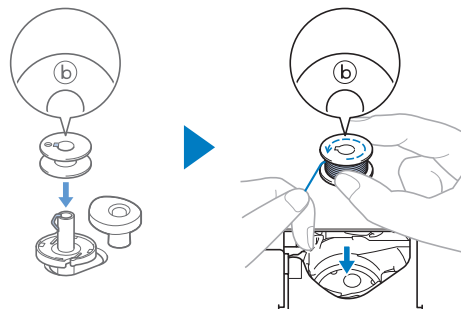

- 5 Lightly hold down the bobbin, and then guide the end of the thread around the tab.**

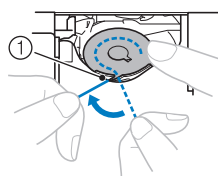

① Tab

💡 Note

Be sure to hold down the bobbin with your finger and unwind the bobbin thread correctly. Otherwise, the thread may break or the thread tension will be incorrect.

- 6 While lightly holding down the bobbin, guide the thread through the slit and lightly pull it.**

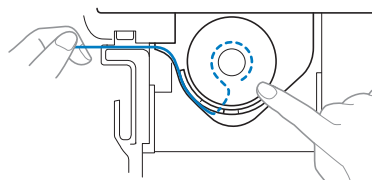

💡 Note

By pulling the thread in this way, the thread will enter the tension spring of the bobbin case to apply the appropriate tension to the bobbin thread during embroidering.

- 7** While lightly holding down the bobbin, continue guiding the thread through the slit. Then, cut the thread with the cutter.

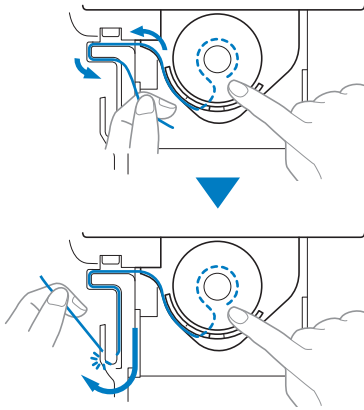

- 8** Reattach the bobbin cover.

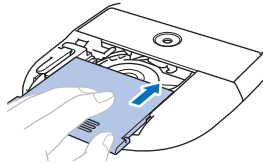

- 9** Hold down ✓ (Accept button).

→ The Accept button LED goes off, and the machine exits Needle/thread exchange mode.

Needle/thread exchange mode

While the machine is in this mode, the Threading position button, Thread cutter button, “Start/Stop” button and Bluetooth button are locked in order to prevent the needle from moving by accident. By using this mode when changing the needle, threading the machine with the upper thread or installing the bobbin, you can safely install or replace the needle.

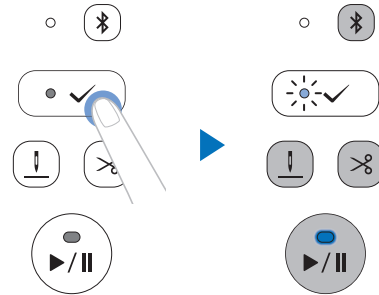

Hold down the Accept button to enter Needle/thread exchange mode. (The “Start/Stop” button LED lights steadily in orange, and the Accept button LED blinks.)

In this mode, each press of the Accept button switches the presser foot between its raised and lowered positions.

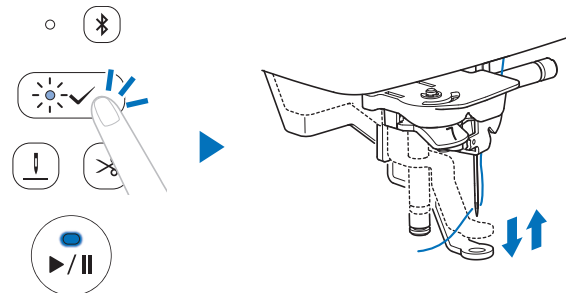

While the machine is in Needle/thread exchange mode, hold down the Accept button to exit the mode.

Attaching the Embroidery Frame

⚠ CAUTION

Do not hit the needle or presser foot with your finger or the embroidery frame. It may cause injury or needle breakage.

💡 Note

- Turn on the machine before attaching the embroidery frame.
- Insert the bobbin wound with thread before attaching the embroidery frame. (page 20)

1 Hold down ✓ (Accept button).

→ The machine enters Needle/thread exchange mode. (page 21)

2 Pass the embroidery frame under the presser foot, and then firmly insert the embroidery frame guide into the embroidery carriage frame holder.

Line up the embroidery frame guide tabs and the embroidery carriage frame holder slots and push in until you hear a click and cannot push the frame any further.

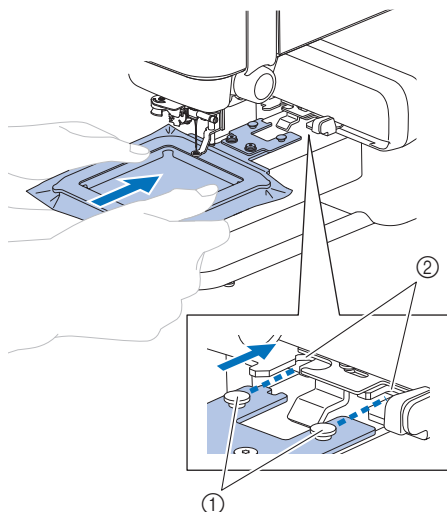

- ① Embroidery frame guide tabs
- ② Embroidery carriage frame holder slots

3 Make sure the lever on the embroidery frame holder opens.

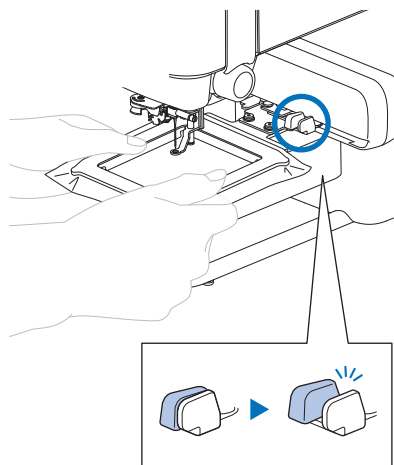

→ The embroidery frame is attached correctly.

⚠ CAUTION

Correctly attach the embroidery frame into the embroidery carriage frame holder. Otherwise, the presser foot may hit the embroidery frame, resulting in injury.

4 Hold down ✓ (Accept button).

→ The Accept button LED goes off, and the machine exits Needle/thread exchange mode.

5 Use "Trial run" to check that the frame moves without catching. Tap [Do a trial run] according to the instructions that appear in the app.

→ The embroidery frame starts the trial run and executes a full range of movement for embroidery.

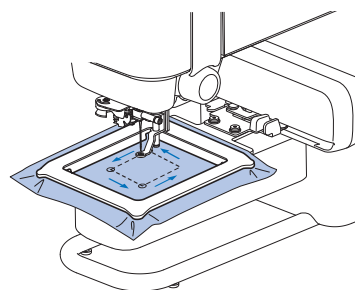

■ Removing the embroidery frame

1 Close the lever on the embroidery frame holder.

→ The embroidery frame will separate from the embroidery carriage frame holder.

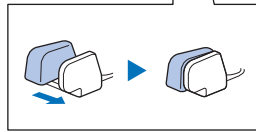
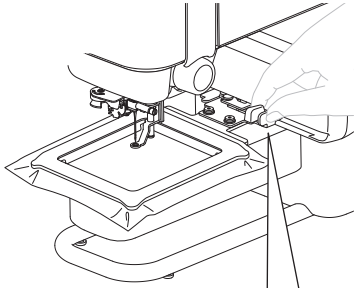

2 Remove the embroidery frame under the presser foot.

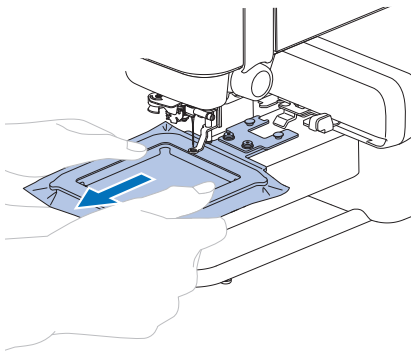

Upper Threading

⚠ CAUTION

When threading the upper thread, carefully follow the instructions. If the upper threading is not correct, the thread may become tangled or the needle may break and cause injury.

Check the information displayed in the app, and thread the machine with the required upper thread.

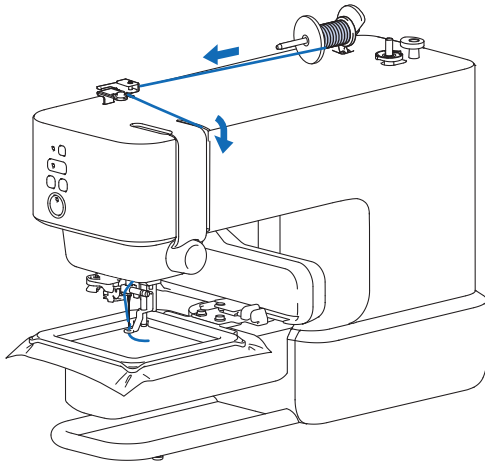

- 1** Press  (Threading position button) to set the needle position to threading ready.

If the needle is not in the threading ready position, the needle threader cannot thread the needle. Depending on the needle position before pressing the button, the needle is lowered once and then raised.

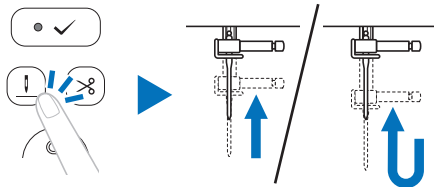

Memo

If the needle is already in a threading ready position, the needle will not move even if the button is pressed.

- 2** Hold down  (Accept button).

→ The machine enters Needle/thread exchange mode. (page 21)

⚠ CAUTION

When threading the needle, be sure to lock all buttons, otherwise injuries may occur if the “Start/Stop” button or any other button is pressed and the machine starts.

- 3** Raise the spool pin and place the spool of thread onto the spool pin.

Make sure that the thread unwinds as shown.

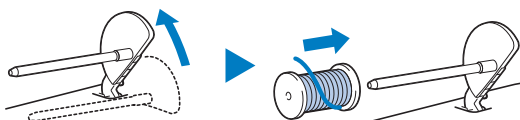

- 4** Slide the spool cap onto the spool pin.

Slide the spool cap as far as possible to the rear, as shown, with the rounded side out.

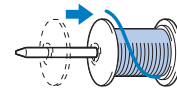

⚠ CAUTION

Choose a spool cap that best fits the size of spool being used. For more information regarding the choice of spool caps for your thread choice, refer to “IMPORTANT” in step 3 of “Winding the bobbin” on page 18.

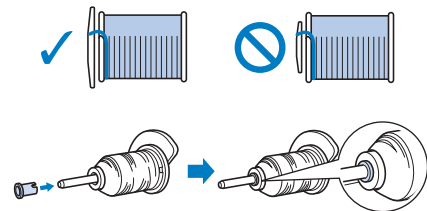

If the spool or the spool cap is not positioned correctly, the thread may become tangled around the spool pin or the needle may break and cause injury.

- 5** Pass the thread under the thread guide.

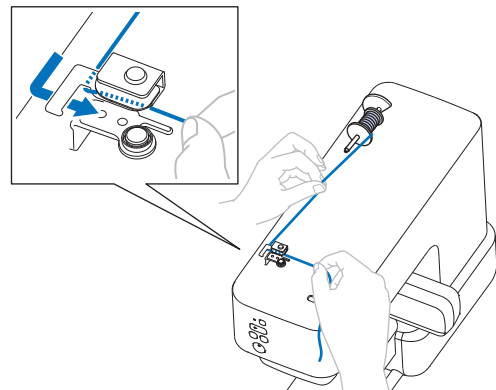

- 6** Pass the thread through the thread channel in the order shown below.

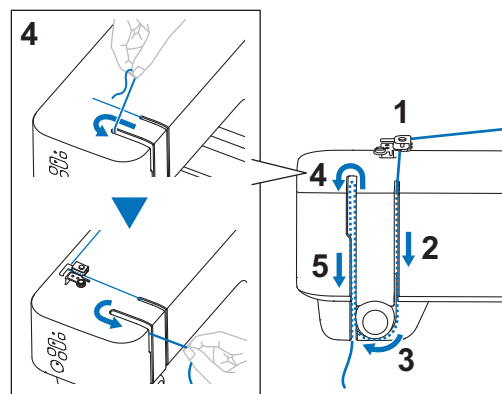

7 Slide the thread behind the needle bar thread guide.

The thread can easily be slid behind the needle bar thread guide by holding the thread in your left hand, then feeding the thread with your right hand. Make sure that the thread is passed through to the left of the tab of the needle bar thread guide.

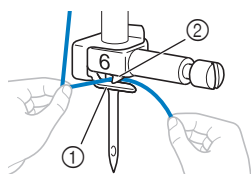

- ① Needle bar thread guide
- ② Tab

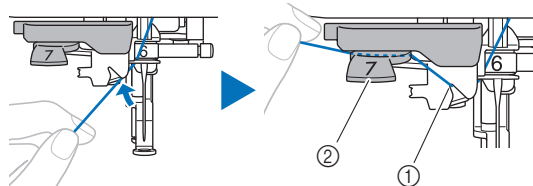
8 Pull the end of the thread, which has been passed through the needle bar thread guide, to the left. Pass the thread through the notch of the thread guide, and then firmly pull the thread from the front and insert it into the slit of the thread guide disk marked "7" all the way.

- ① Notch of the thread guide
- ② Thread guide disk

9 Press ✓ (Accept button).

→ Presser foot is lowered.

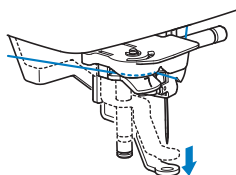
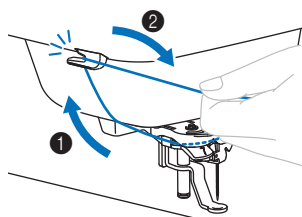
**10 Cut the thread with the thread cutter on the left side of the machine.****Note**

When using thread that quickly winds off the spool, such as metallic thread, it may be difficult to thread the needle if the thread is cut. Therefore, instead of using the thread cutter, pull out about 8 cm (approx. 3 inches) of thread after passing it through the thread guide disk (marked "7").

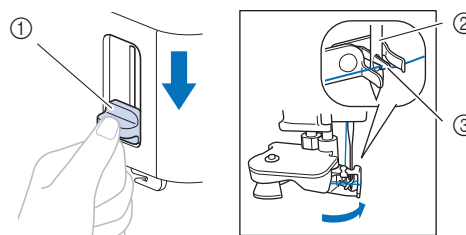
11 Lower the needle threader lever on the left side of the machine as much as possible to make the hook turn.

- ① Needle threader lever
- ② Needle
- ③ Hook

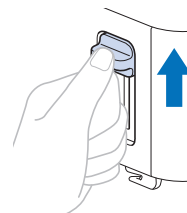
12 Raise the needle threader lever slowly.**13 Carefully pull the end of thread that was passed through the eye of the needle.**

If the needle was not completely threaded, but a loop in the thread was formed in the eye of the needle, carefully pull the loop through the eye of the needle to pull out the end of the thread.

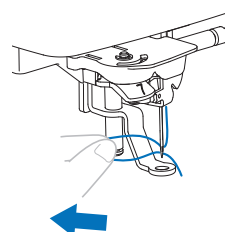
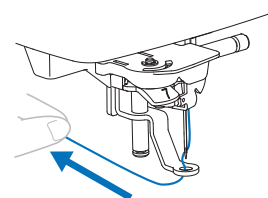
**14 Pass the end of the thread through and under the presser foot, and then pull out about 10 cm (approx. 4 inches) of thread toward the rear of the machine.****15 Hold down ✓ (Accept button).**

→ The Accept button LED goes off, and the machine exits Needle/thread exchange mode.

Embroidering a Pattern

Prepare embroidery thread colors as shown on the app. Embroidery patterns are embroidered with a change of thread after each color.

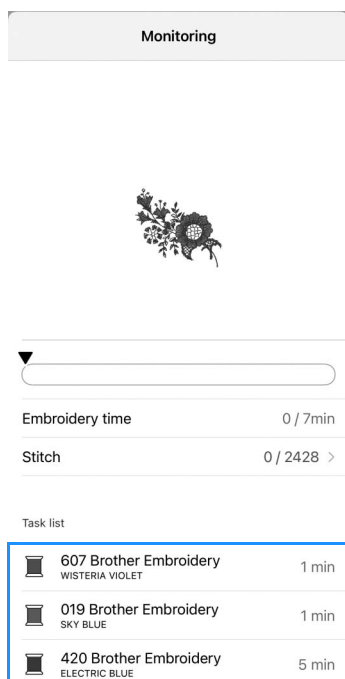

- 1 Pass the thread through the presser foot hole, and hold it lightly in your left hand.
Give the thread a little slack.

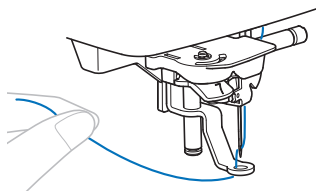

⚠ CAUTION

When embroidering on large garments, place the fabric on a table so that it does not hang down or extend out. Otherwise, the embroidery unit cannot move freely and the embroidery frame may strike the needle, causing the needle to break and possibly causing injury.

- 2 Press the “Start/Stop” button to start embroidering. After 5-6 stitches, press the “Start/Stop” button again to stop the machine.

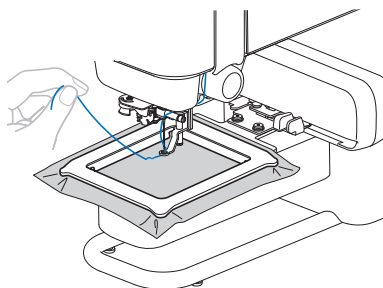

💡 Note

Make sure to prevent any objects or fabric outside of the embroidery frame from overlapping the moving area of the embroidery frame. If the embroidery frame hits another object, the pattern may become misaligned.

- 3 Trim the excess thread at the end of the seam.

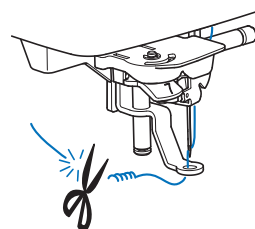

If the thread is left at the beginning of the stitching, it may be embroidered over as you continue embroidering the pattern, making it very difficult to remove the excess thread after the pattern is finished. Trim the thread at the beginning.

- 4 Press the “Start/Stop” button to start embroidering.

→ Stitching stops automatically with reinforcement and thread cutting after one color has been completed.

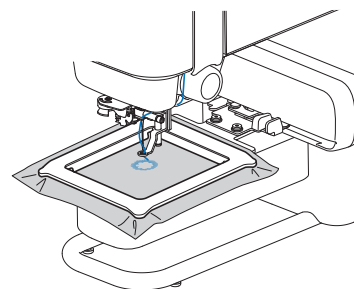

- 5 Remove the thread for the first color from the machine.
- 6 Repeat the same steps for embroidering the remaining colors.

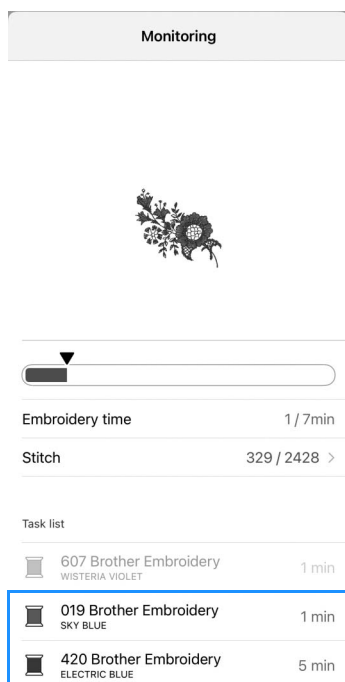

→ When the last color is embroidered, the message informing that the embroidering is finished will appear on the app. Follow the instructions in the app to continue embroidering or set another embroidery pattern.

■ If the thread breaks or the bobbin runs out of thread during embroidering

• If the upper thread is broken

 : App

- 1 Tap [Close] to close the error message.
- 2 Tap [Stitch] in the app.
- 3 Tap <, << or <<< to move the needle back the correct number of stitches before the area where the thread broke, and then tap [Done].

 : Machine

- 4 Press ✓ (Accept button).
→ The Accept button LED goes off.
- 5 Press  (Thread cutter button) to cut the upper and bobbin threads.
- 6 Thread the upper thread again. (page 24)
- 7 Press the “Start/Stop” button to continue embroidering.

• If the bobbin runs out of thread

 : App

- 1 Tap [Move the frame to the Attach/Detach position] to cut the threads and move the frame to a position where it is easier to remove.
- 2 Follow steps 1 to 3 of “If the upper thread is broken”, above.

 : Machine

- 3 Press ✓ (Accept button).
→ The Accept button LED goes off.
- 4 Remove the embroidery frame. (page 23)
- 5 Install the bobbin thread again. (page 20)
- 6 Attach the embroidery frame again. (page 22)
- 7 Press the “Start/Stop” button to continue embroidering.

If the error still appears after replacing the thread, check the following.

- Check if the machine is exposed to strong light. If the machine is exposed to strong light such as direct sunlight or a spotlight, the thread sensor may malfunction.
- In the case of upper thread error, make sure that the thread is passed into the thread take-up lever.

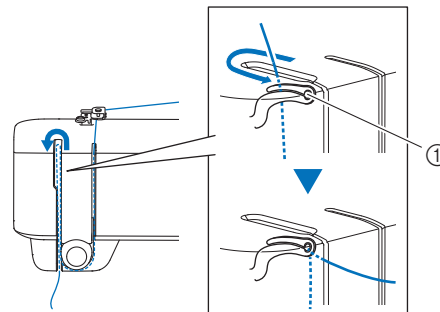

① Thread take-up lever

■ Resuming embroidery after turning off the power

The current color and stitch number are saved when embroidery is stopped. The next time the machine is turned on, you have the option to continue or delete the pattern at the app.

Adjusting Thread Tension

The upper thread tension is changed using the thread tension dial.

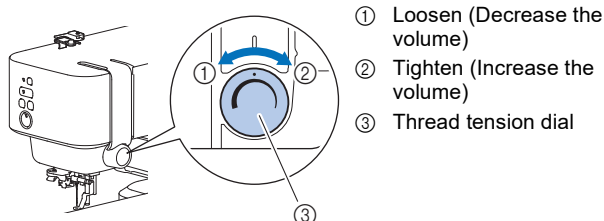

Note

If the stitches appear loose, turn the tension up one notch and embroider again.

Correct thread tension

The thread tension is correct when upper thread is just visible on the wrong side (bottom) of the fabric.

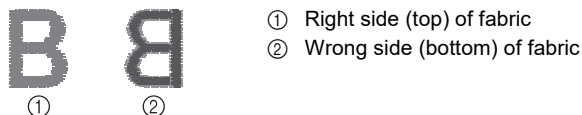

Upper thread is too tight

The bobbin thread will be visible on the right side (top) of the fabric. In this instance, decrease the upper thread tension.

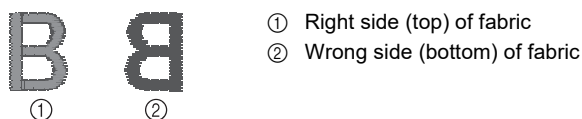

Upper thread is too loose

The upper thread has slack. In this instance, increase the upper thread tension.

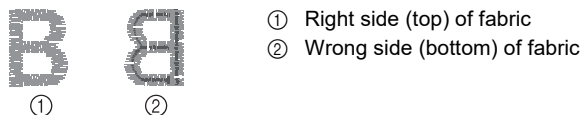

Note

If the upper thread is not threaded correctly or the bobbin is not installed correctly, it may not be possible to set the correct thread tension. If the correct thread tension cannot be achieved, rethread the upper thread and insert the bobbin correctly.

Chapter 3 APPENDIX

Care and Maintenance of the Machine

⚠ CAUTION

- Unplug the power cord before cleaning the machine, otherwise injuries may occur.

Cleaning the machine surface

When wiping dirt off the machine, firmly wring a soft cloth soaked in (lukewarm) water.

After cleaning the machine, dry it with a soft, dry cloth.

Restrictions on oiling

In order to prevent damaging this machine, it must not be oiled by the user.

This machine was manufactured with the necessary amount of oil applied to ensure correct operation, making periodic oiling unnecessary.

If problems occur, such as difficulty turning the handwheel or an unusual noise, immediately stop using the machine, and contact your authorized Brother dealer or the nearest Brother authorized service center.

Precautions on using and storing the machine

Do not use or store the machine in any of the locations described below, otherwise damage or malfunction to the machine may result, for example, rust caused by condensation.

- Exposed to extremely high temperatures
- Exposed to extremely low temperatures
- Exposed to extreme temperature changes
- Exposed to high humidity or steam
- Near a flame, heater or air conditioner
- Outdoors or exposed to strong light such as direct sunlight or spot lighting
- Exposed to extremely dusty or oily environments

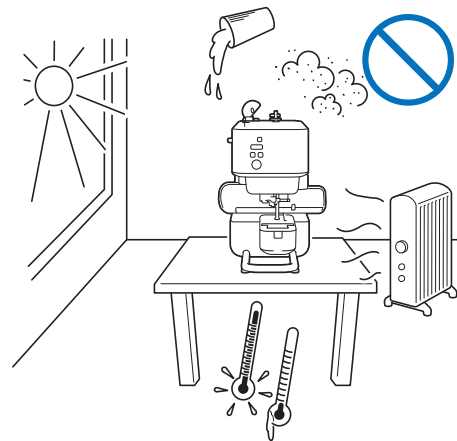

Note

In order to extend the life of this machine, periodically turn it on and use it. Storing this machine for an extended period of time without using it may reduce its efficiency.

Cleaning the race

Stitching performance will suffer if lint and dust collects in the bobbin case, therefore, it should be cleaned regularly.

- 1 Press  (Threading position button) to raise the needle.
- 2 Remove the needle. (page 32)
- 3 Turn off the machine.
- 4 Unplug the power cord from the power supply jack.
- 5 Remove the needle plate cover.

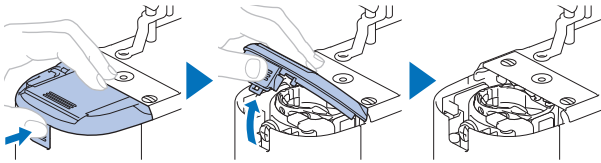

- 6 Remove the bobbin case, and use the cleaning brush or a vacuum cleaner to remove any lint and dust from the race and bobbin thread sensor and the surrounding area.

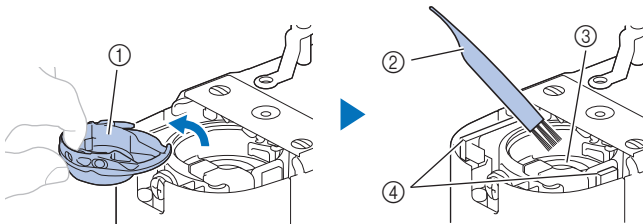

- ① Bobbin case
- ② Cleaning brush
- ③ Race
- ④ Bobbin thread sensor

- 7 Insert the bobbin case so that the ▲ mark on the bobbin case aligns with the ● mark on the machine.

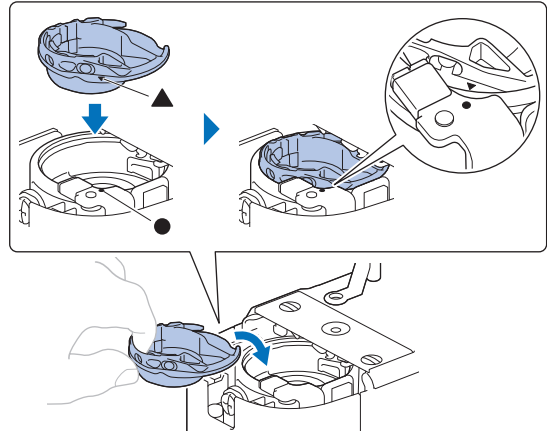

CAUTION

- Never use a bobbin case that is scratched or has a burr on it. Otherwise the upper thread may become tangled, the needle may break and cause injury. For a new bobbin case, contact your nearest Brother authorized service center.
- Be sure that the bobbin case is correctly installed, otherwise the needle may break and cause injury.

- 8 Attach the needle plate cover.

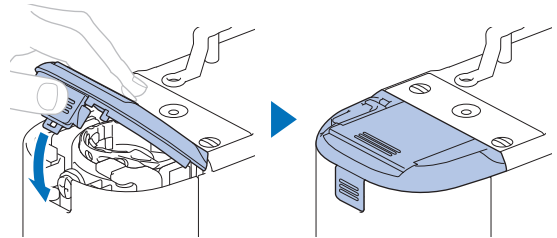

- 9 Follow step 6 of “Replacing the needle” on page 32 for attaching the needle.

Replacing the Needle

⚠ CAUTION

- Only use recommended home sewing machine needles. Use of any other needle may break the needle, possibly resulting in injury.
- Never use bent needles. Bent needles can easily break, possibly resulting in injuries.

■ Thread and needle number

The lower the thread number is, the heavier the thread; the higher the needle number, the larger the needle.

■ Embroidery needles

It is recommended to use a 75/11 home sewing machine needle. However, if the machine is not stitching well when embroidering on heavy weight fabric, please try a 90/14 needle.

Checking the needle

Before using the needle, place the flat side of the needle on a flat surface and check that the distance between the needle and the flat surface is even.

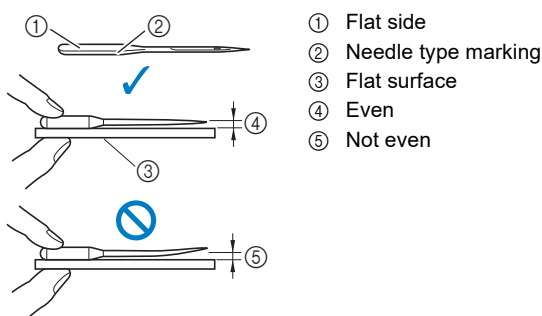

💡 Note

The machine needles are consumables. Replace the needle in cases such as those described below.

- If an unusual sound is produced when the needle enters the fabric. (The tip of the needle may be broken or dull.)
- If stitches are skipped. (The needle may be bent.)

Replacing the needle

Use the screwdriver and a new needle that has been determined to be straight according to the instructions in "Checking the needle" on page 32.

- 1 Press  (Threading position button) to raise the needle.**
- 2 Place fabric or paper under the presser foot to cover the hole in the needle plate to prevent the needle from falling into the machine.**

- 3 Hold down  (Accept button).**

→ The machine enters Needle/thread exchange mode. (page 21)

⚠ CAUTION

When replacing the needle, be sure to lock all buttons, otherwise injuries may occur if the "Start/Stop" button or any other button is pressed and the machine starts.

- 4 Press  (Accept button).**

→ Presser foot is lowered.

- 5 Hold the needle with your left hand, and then use a screwdriver to turn the needle clamp screw toward you (counterclockwise) to remove the needle.**

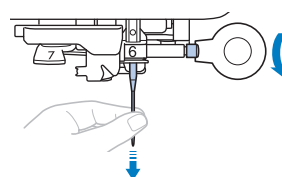

Do not apply a strong force when loosening or tightening the needle clamp screw, otherwise certain parts of the machine may be damaged.

- 6 With the flat side of the needle toward the rear of the machine, insert the new needle until it touches the needle stopper. Using the screwdriver tighten the needle clamp screw by turning it clockwise.**

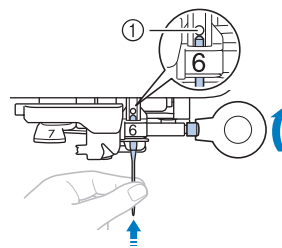

① Needle stopper

⚠ CAUTION

Be sure to insert the needle until it touches the needle stopper and securely tighten the needle clamp screw with the screwdriver, otherwise the needle may break and cause injury.

- 7 Hold down  (Accept button).**

→ The Accept button LED goes off, and the machine exits Needle/thread exchange mode.

Troubleshooting

LED indications

• Bluetooth button

Lighting condition	Machine status	Reference
Lights steadily	The machine is now connected to the mobile device.	13
Blinking pattern 1 (3 sec. interval)	The machine is not connected.	13
Blinking pattern 2 (1.5 sec. interval)	Preparing for pairing: The app to be paired has not yet been selected, such as while specifying initial settings or reconnecting.	13
Blinking pattern 3 (0.5 sec. interval)	Preparing for pairing: The app to be paired has been selected, but a connection is not yet established. (When the machine is turned on for subsequent times, when the connection with the app is lost, etc.)	13, 33
Blinking pattern 4 (0.25 sec. interval)	Data is being received.	—

• Accept button

Lighting condition	Machine status	Reference
Blinking	The machine status differs depending on the color of the "Start/Stop" button LED. <ul style="list-style-type: none"> If the "Start/Stop" button LED lights steadily in orange, the machine is in Needle/thread exchange mode. Hold down the Accept button to exit Needle/thread exchange mode. If the "Start/Stop" button LED is off, the machine is ready to set the embroidery carriage to the initial position, or for a "Trial run". Follow the instructions in the app. If the "Start/Stop" button LED lights steadily in red, a machine error, such as a broken thread, has occurred and needs to be resolved. Follow the instructions in the app to resolve the corresponding error, and then press the Accept button. 	21

• "Start/Stop" button

Lighting condition	Machine status	Reference
Lights steadily in green	The machine is embroidering. Press this button to stop embroidering.	26
Blinks in green	Ready to embroider. Press this button to start embroidering. (Blinks after data reception is finished or when a different thread color should be installed.)	26

Lighting condition	Machine status	Reference
Lights steadily in orange	In Needle/thread exchange mode or the bobbin is being wound. <ul style="list-style-type: none"> In Needle/thread exchange mode, the Accept button LED blinks. In this mode, nothing happens when this button is pressed. If this button is pressed while the bobbin is being wound, bobbin winding stops. 	18, 21
Blinks in orange	Ready to wind the bobbin. Press this button to start winding the bobbin. <ul style="list-style-type: none"> To cancel this ready state without winding the bobbin, move the bobbin winder shaft toward the front of the machine. 	18
Lights steadily in red	An error has occurred. Follow the instructions in the app to resolve the issue. You can check the details from the  icon on the top left of the home screen.	—
Blinks green, red, and orange repeatedly	The machine software is being updated.	38
Off	Since pattern data has not yet been received, nothing happens when this button is pressed.	—

If a communication error occurs

If a communication error between your mobile device and the machine occurs, confirm the following conditions to solve the problem:

- Is the machine on?
 - Make sure the machine is turned on.
- Is the distance between the machine and your mobile device too far?
 - Make sure the machine and your mobile device are close enough to communicate.
- Is any device that emits radio waves, such as a microwave oven, interfering with the communication?
 - Make sure no devices that emit radio waves are nearby.
- Is your mobile device's Bluetooth setting turned on?
 - Check your mobile device's Bluetooth settings.

If the error between the mobile device and the machine that is being paired with the app persists, unpair it and try pairing again.

- 1** In the home screen, tap .
- 2** Tap the machine being paired to open the machine's settings.
- 3** Tap [Delete].
- 4** Open the mobile device's Bluetooth setting.
- 5** Delete the connection information of the machine to unpair with the machine.
- 6** Pair with the machine again. (page 13)

If the thread becomes tangled under the bobbin winder seat

If the bobbin winding starts when the thread is not passed under the pretension disk of the thread guide correctly, the thread may become tangled under the bobbin winder seat.

⚠ CAUTION

- Do not remove the bobbin winder seat even if the thread becomes tangled under the bobbin winder seat. Otherwise, there is a risk of being injured by the cutter of the bobbin winder seat.
- Do not remove the screw on the bobbin winder guide post, otherwise the machine may be damaged; you cannot wind off the thread by removing the screw.

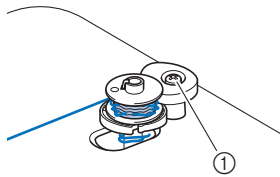

① Screw of the bobbin winder guide post

- 1 Stop the bobbin winding.**
- 2 Cut the thread with scissors beside the thread guide.**
- 3 Slide the bobbin winder shaft toward the front, and then remove the bobbin from the shaft and cut the thread leading to the bobbin in order to be able to completely remove the bobbin from shaft.**
- 4 Hold the thread end with your left hand, and wind off the thread clockwise from under the bobbin winder seat with your right hand as shown below.**

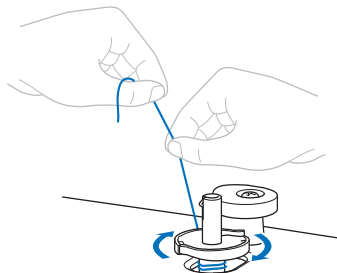

List of symptoms

If the machine stops operating correctly, check the following possible problems before requesting service. You can solve most problems by yourself. If you need additional help, Brother support website offers the latest FAQs and troubleshooting tips. Visit us at <https://s.brother/cpuaa/>.



If the problem persists or the reference is "*", contact your authorized Brother dealer or the nearest Brother authorized service center.

■ Getting ready

Symptom, Cause/Solution	Reference
Cannot thread the needle.	
Needle is not in the correct position. • Press the "Threading position" button to raise the needle.	24
Upper threading is incorrect.	24
Needle is installed incorrectly.	32
Needle is turned, bent or the point is dull.	32
The needle threader hook is bent and does not pass through the eye of the needle.	*
The needle threader lever cannot be moved or returned to its original position.	*
Bobbin thread does not wind neatly on the bobbin.	
The thread is not passed through the thread guide correctly.	18
The thread that was pulled out from the thread guide was incorrectly wound onto the bobbin.	18
The empty bobbin was not set on the pin properly.	18
While winding the bobbin, the bobbin thread was wound below the bobbin winder seat.	
The thread was incorrectly passed under the pretension disk on the thread guide. • Remove any entangled thread, and then wind the bobbin.	18, 34
The pattern is not transferred from the app.	
The machine and mobile device are not connected via Bluetooth.	13, 17, 33
A machine different than the one to be used was selected when the data was transferred from the Artspira app.	13
The machine's software has not been updated to the latest version.	38
The Artspira app has not been updated to the latest version.	-

■ While embroidering

Symptom, Cause/Solution	Reference
Machine does not operate.	
"Start/Stop" button was not pressed.	26
The bobbin winder shaft is pushed to the rear. ("Start/Stop" button LED blinks in orange) • To start embroidering, move the bobbin winder shaft toward the front of the machine.	-
There is no pattern transferred from the app.	17
The machine is in Needle/thread exchange mode.	21
Needle breaks.	
Needle is installed incorrectly.	32
Needle clamp screw is not tightened.	32
Needle is turned or bent.	32
Using improper needle or thread for the selected fabric.	32
There are scratches around the opening in the needle plate.	*
There are scratches near the hole in the presser foot.	*
Upper threading is incorrect.	24
Upper thread tension is too tight.	29
Bobbin is set incorrectly.	18
Bobbin thread is incorrectly wound.	18
A bobbin designed specifically for this machine is not used.	18
There are scratches on the bobbin case.	*
Fabric is too thick. • Use fabrics with a thickness of less than 2 mm (approx. 1/16 inch).	14
Stabilizer is not attached to fabric being embroidered.	15
Upper thread breaks.	
The machine is not threaded correctly (wrong spool cap is used, spool cap is loose, thread was not passed through the needle bar thread guide, etc.).	24
Knotted or tangled thread is being used.	-
Thread is tangled.	-
Upper thread tension is too tight.	29
Needle is installed incorrectly.	32
Needle is turned, bent or the point is dull.	32
Using improper needle or thread for the selected fabric.	32
There are scratches around the opening in the needle plate.	*
There are scratches near the hole in the presser foot.	*

Symptom, Cause/Solution	Reference
A bobbin designed specifically for this machine is not used.	18
There are scratches on the bobbin case.	*
The thread is tangled on the wrong side of the fabric.	
Upper threading is incorrect.	24
Using improper needle or thread for the selected fabric.	32
The upper thread is too tight.	
Bobbin is set incorrectly.	18
Upper threading is incorrect.	24
Thread tension is set incorrectly.	29
Bobbin thread breaks.	
Bobbin is set incorrectly.	18
Bobbin thread is incorrectly wound.	18
A scratched bobbin is being used.	18
A bobbin designed specifically for this machine is not used.	18
Embroidery bobbin thread intended for use with this machine is not being used.	18
Thread is tangled.	-
Fabric puckers.	
Bobbin is set incorrectly.	18
Embroidery bobbin thread intended for use with this machine is not being used.	18
Upper threading is incorrect.	24
Stabilizer is not attached to fabric being embroidered.	15
Using improper needle or thread for the selected fabric.	32
Needle is turned, bent or the point is dull.	32
Skipped stitches	
Using improper needle or thread for the selected fabric.	32
Bobbin is set incorrectly.	18
Embroidery bobbin thread intended for use with this machine is not being used.	18
Upper threading is incorrect.	24
Needle is turned, bent or the point is dull.	32
Needle is installed incorrectly.	32
Dust or lint has collected under the needle plate.	31

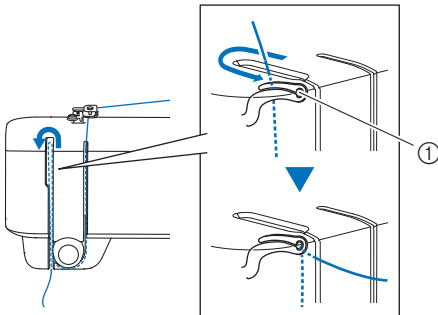
Symptom, Cause/Solution	Reference
Not embroidering	
Needle is turned, bent or the point is dull.	32
Bobbin is set incorrectly.	18
Upper threading is incorrect. <ul style="list-style-type: none"> Make sure that the thread is passed into the thread take-up lever. 	24
 <p>① Thread take-up lever</p>	
High-pitched sound while embroidering	
Pieces of thread are caught in the race.	31
Upper threading is incorrect.	24
A bobbin designed specifically for this machine is not used.	18
There are needle holes or friction scratches in the bobbin case.	*
The needle contacts the needle plate.	
The needle clamp screw is loose.	32
Needle is turned, bent or the point is dull.	32
The handwheel does not turn smoothly.	
Thread is tangled in the bobbin case.	-

■ After embroidering

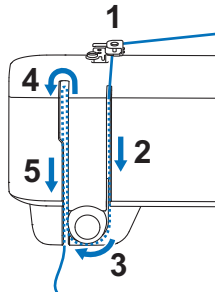
Symptom, Cause/Solution	Reference
Thread tension is incorrect.	
Upper threading is incorrect. <ul style="list-style-type: none"> Make sure that the presser foot is lifted during threading procedure shown below. 	24
	
Thread tension is set incorrectly.	29
Bobbin thread is incorrectly wound.	18
Bobbin is set incorrectly.	18

Symptom, Cause/Solution	Reference
A bobbin designed specifically for this machine is not used.	18
Embroidery bobbin thread intended for use with this machine is not being used.	18
Using improper needle or thread for the selected fabric.	32
Needle is turned, bent or the point is dull.	32
Embroidery pattern does not embroider correctly.	
Thread is twisted.	-
Thread tension is set incorrectly.	29
Fabric was not inserted into the frame correctly (fabric was loose, etc.).	15
Stabilizing material was not attached. <ul style="list-style-type: none"> Always use stabilizing material, especially with stretch fabrics, lightweight fabrics, fabrics with a coarse weave, or fabrics that often cause pattern shrinkage. See your authorized Brother dealer for the proper stabilizer. 	15
Stabilizer is incorrectly attached, for example, it is smaller than the embroidery frame.	15
Fabric coming out of the embroidery frame is causing problems. <ul style="list-style-type: none"> Stretch the fabric on the frame once again so that the fabric coming out of the embroidery frame does not cause problems, rotate the pattern and embroider. 	16, 22
There was an object placed near the machine, and the embroidery carriage or embroidery frame hit the object during embroidering. <ul style="list-style-type: none"> Before embroidering, use "Trial run" to check that the frame moves without catching. 	22
Fabric is snagged or caught on something. <ul style="list-style-type: none"> Stop the machine and place the fabric so that it does not get caught or snagged. Before embroidering, use "Trial run" to check that the frame moves without catching. 	22
The embroidery carriage was moved while the embroidery frame was being removed or attached during embroidering. <ul style="list-style-type: none"> If the embroidery carriage is moved during the process, the pattern may be misaligned. Be careful when removing or attaching the embroidery frame. 	22
A heavy fabric is being embroidered, and the fabric is hanging off the table. <ul style="list-style-type: none"> If embroidery is done with the fabric hanging off the table, the embroidery unit movement will be impaired. Support the fabric while embroidering. 	26
Embroidery pattern does not embroider in a particular position.	
Fabric is not positioned with the proper position in the embroidery frame. <ul style="list-style-type: none"> Use the [Camera scan] function. 	16
Loops appear on the surface of the fabric when embroidering.	
Thread tension is set incorrectly.	29
Embroidery bobbin thread intended for use with this machine is not being used.	18

Error messages

If an operation is performed incorrectly, an error message appears. If an error message appears in the app, follow the instructions given in the error message to correct the problem.

The following website provides step-by-step instructions for resolving issues.

<https://s.brother/cquka/>



	Error messages	Cause/Solution
1	Attach a needle plate cover	This message is displayed when the needle plate cover is removed or attached incorrectly. Refer to the step 8 of "Cleaning the race" on page 31 to attach the needle plate cover.
2	Check and rethread the upper thread	This message is displayed when the upper thread is threaded incorrectly or running out. Rethread the upper thread. (page 24) If the upper thread is running out during embroidering, refer to "If the thread breaks or the bobbin runs out of thread during embroidering" on page 28.
3	Preventive maintenance is recommended	Once this message appears, it is recommended to take your machine to an authorized Brother dealer or the nearest Brother authorized service center for a regular maintenance check. Although this message will disappear and the machine will continue to function, the message will display several more times until the appropriate maintenance is performed.
4	Stitch count cannot be changed	This message is displayed when the number of the stitch that has been changed on the app cannot be sent to the machine. The number of the stitch cannot be changed while embroidering. Press the "Start/Stop" button to stop the machine and send the number of the stitch again.
5	The bobbin thread is almost empty	This message is displayed when the bobbin thread is running out. Replace with a wound bobbin immediately. (page 18) If the bobbin thread is running out during embroidering, refer to "If the thread breaks or the bobbin runs out of thread during embroidering" on page 28.
6	The connection with the machine has been lost	This message is displayed when the communication error has occurred with the machine being paired. Refer to "If a communication error occurs" on page 33 to solve the problem.
7	The machine stopped due to an error	If this message is displayed, the machine may be malfunctioning. Contact your authorized Brother dealer or the nearest Brother authorized service center.
8	The safety device has been activated	This message is displayed when the motor locks due to tangled thread or for other reasons related to thread delivery. <ul style="list-style-type: none"> If an error occurs while embroidering: <ul style="list-style-type: none"> After turning off the machine, clean the race to remove the tangled threads. (page 31) Install the bobbin case and the bobbin correctly. (page 20, page 31) If the needle is bent, replace the needle. (page 32) And then thread the upper thread correctly. (page 24) If an error occurs while winding the bobbin: <ul style="list-style-type: none"> Remove the thread from the bobbin winder. (page 34)

Updating Your Machine's Software

The machine's software can be updated with the app. Follow the app instructions to update the machine.

Update information can be viewed in the app.

■ Checking and updating the software

- 1 In the home screen, tap .**
- 2 Tap the machine name being connected to the app.**
- 3 Tap [Software Version].**
→ The software update information can be viewed.
- 4 If the software update is required, read the terms of use and tap [Agree] to send update data to the machine.**

During the update process, the machine's "Start/Stop" button LED lights up in various colors. After a while, the machine will automatically reboot and a beep will sound to indicate that the update process is finished. After the machine is reconnected with the app, you can continue using the machine.

IMPORTANT

Do not turn off the machine during the update process. Otherwise the machine may be malfunctioning.

Before Lending or Disposing of the Machine

Please be sure to reset your machine to delete the following data.

- All saved data
- Customized settings
- Connection information

- 1 In the home screen, tap .**
- 2 Tap the machine name being connected to the app.**
- 3 Tap [Reset to default].**

When you agree to the confirmation message, the app will communicate with the machine and the information of the machine will be deleted.

Do not turn off the machine during the process.

Specifications

Item	Specification
Dimensions of machine	437 mm (W) × 230 mm (D) × 318 mm (H) (Approx. 17-3/16 inches (W) × 9-1/32 inches (D) × 12-1/2 inches (H))
Weight of machine	Approx. 7.6 kg (Approx. 17 lb)
Maximum embroidery speed	400 stitches per minute
Interfaces	Bluetooth Ver.5.0 (Bluetooth Low Energy)
Maximum embroidering area	100 mm × 100 mm (Approx. 4 inches × 4 inches)

INDEX

A

Adjusting the position	16
Artspira app	13

B

Bluetooth	13
Bobbin	18
Bobbin case	31
Bobbin cover	20
Bobbin installation	20
Bobbin thread	11, 18
Bobbin winding	18

C

Camera scan function	16
Cleaning	30
Connecting	13
Connection error	33

E

Embroidery	14
Embroidery frame (Attaching the embroidery frame)	22
Embroidery frame (Hooping the fabric)	14
Embroidery frame (Removing the embroidery frame)	23
Error messages	37

F

Fabric	14
--------------	----

L

LED	33
-----------	----

M

Magnetic frame	14
Maintenance	30
Metallic thread	25

N

Needle	32
Needle plate	10
Needle plate cover	10, 31
Needle threading	25

P

Pairing	13
Power supply	12
Presser foot	10
Pre-wound bobbin	11

R

Race	31
------------	----

S

Spool cap	18
Stabilizer	15

T

Terms of Use	6
--------------------	---

Thread	11
Thread tension	29
Trial run	22
Troubleshooting	33

U

Updating	38
Upper thread	11, 24

Various optional accessories are available to be purchased separately.

Visit our website <https://s.brother/ccuaa/>.



Please visit <https://s.brother/cpuaa/> where you can get the support information (Instructional Videos, FAQs, etc.) for your Brother product.



Be sure to install the latest software.

A variety of functional improvements are being performed in the latest version.



Brother SupportCenter is a mobile app that provides the support information for your Brother product.

Visit the Google Play or App Store to download.



This machine is approved for use in the country of purchase only. Local Brother companies or their dealers will only support machines purchased in their own countries.

